

East Falls Church Metrorail Station Bus Bay Expansion

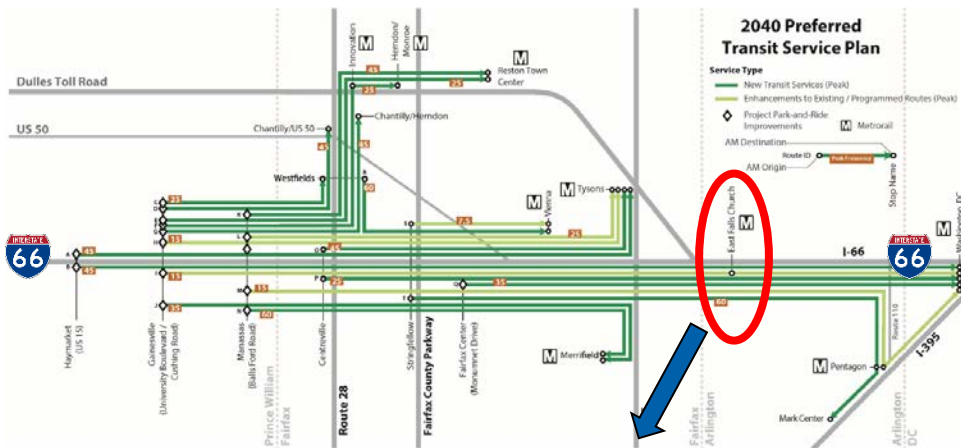

- Location: Arlington, VA
- Anticipated Completion: Summer 2020
- Requested Funds: \$4.8M

■ Project Description:

- Adds up to three new bus bays and replaces existing shelters
- Pedestrian access improvements from the park-and-ride lot, improvements to the accessible parking access, and the addition of a signal and crosswalk at the entrance to the park-and-ride lot on Washington Boulevard

■ Project Benefits:

- Reduces congestion, moves more people, and increases travel options.
- Meets the needs of WMATA and other local/regional bus services by providing additional bus bays at an existing Metrorail station
- Provides opportunity for additional I-66 Outside the Beltway proposed transit service to connect to the Metrorail and Arlington